

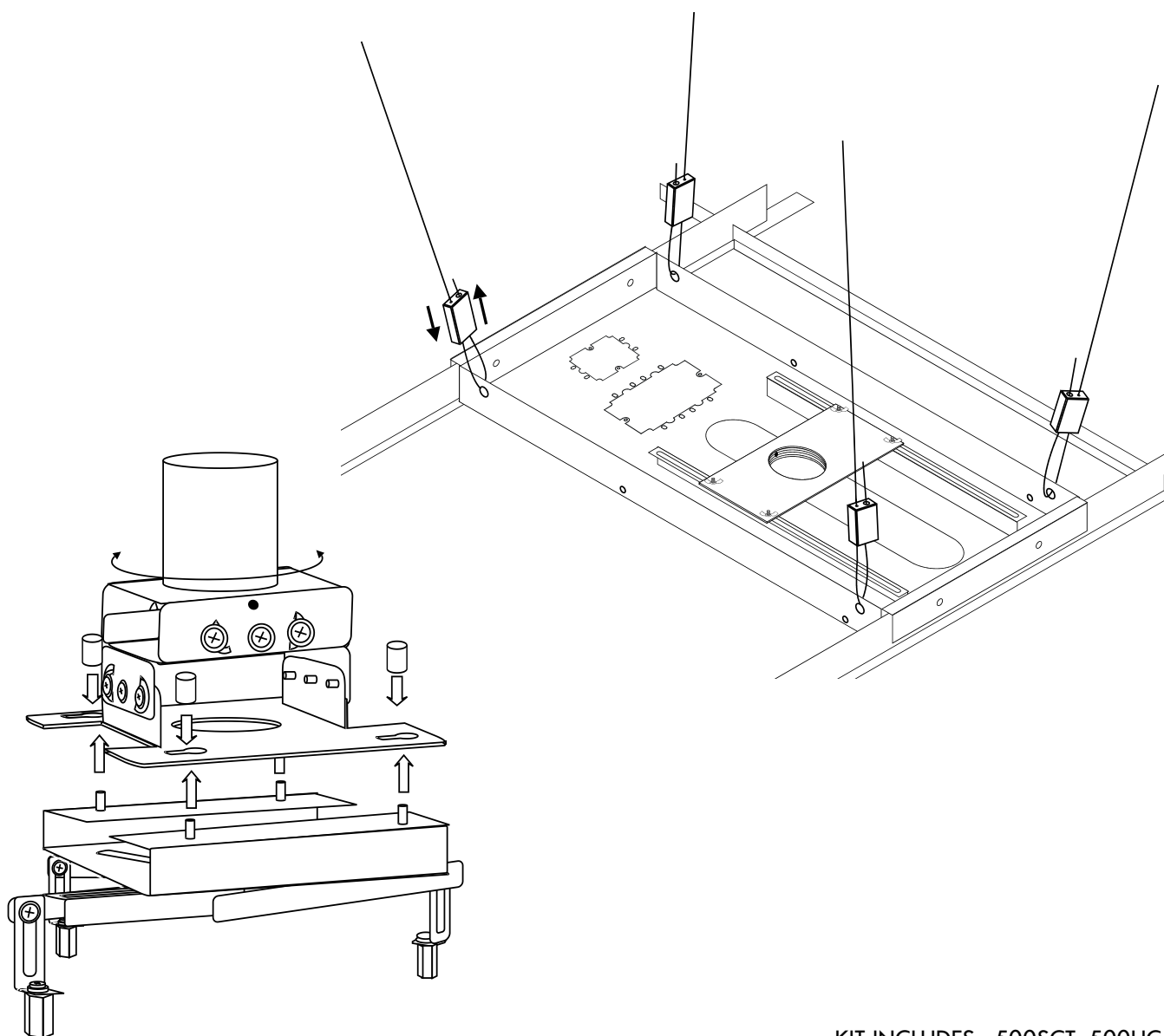

# Installation Guide

## Infinix SCM

Lightweight Suspended Ceiling Projector Mount Kit



# ***General Information***

## **Copyright**

Copyright ©2008 Recordex USA, Inc. All rights reserved. No part of this user's guide may be reproduced in any form without the express written permission of Recordex USA, Inc. Note: User's are permitted to print copies of this guide for personal use.

## **Trademarks**

Recordex and all Recordex product name are the registered trademarks of Recordex USA, Inc. All other trademarks acknowledged.

## **Disclaimer**

The information in this document is subject to change without notice.

RECORDEX USA, INC. MAKES NO WARRANTY OF ANY KIND WITH REGARD TO THIS MATERIAL, EITHER EXPRESS OR LIMITED, EXCEPT AS PROVIDED HEREIN, INCLUDING WITHOUT LIMITATION, THEREOF, WARRANTIES AS TO MARKETABILITY, MERCHANTABILITY, FITNESS FOR A PARTICULAR PURPOSE OF USE OR AGAINST INFRINGEMENT OF ANY PATENT. RECORDEX USA, INC. SHALL NOT BE LIABLE FOR ANY DIRECT, INCIDENTAL, OR CONSEQUENTIAL DAMAGES OF ANY NATURE, OR LOSSES EXPENSES RESULTING FROM THE USE OF THIS MATERIAL.

## **Information & Support**

Before calling for support please read the user's guide. Should service be necessary please contact the Recordex Reseller who sold you the Infinix SCM, or contact us using the contact information below.

Recordex USA, Inc.  
PO Box 848  
105 North Anderson Drive  
Swainsboro, GA 30401  
1-478-237-5501

## Warranty

### Limited 10-year Warranty on Infinix SCM™ Lightweight Suspended Ceiling Projector Mount Kit

**What is my warranty?** Recordex warrants to the original purchaser only that the Mounting Kit will be free from defects in material and workmanship under normal use for a period of ten (10) years from the date of original purchase. However, Recordex does not warrant against failures related to improper installation or improper use. Recordex's warranty shall not apply: (i) to any autoprinter subjected to accident, misuse, neglect, alteration, acts of God, improper handling, improper transport, improper storage, improper use or application, improper installation, improper testing or unauthorized repair; or (ii) to cosmetic problems or defects that result from normal wear and tear under ordinary use, and do not affect the performance or use of the product. If the Mounting Kit develops a covered defect within the first year, Recordex will, at its option, either repair or replace the Mounting Kit at no charge, provided that the original Mounting Kit is returned during the warranty period.

**How long does this warranty last?** Ten (10) years from the date of the original purchase.

**Who is responsible for Shipping?** You are responsible for shipping the defective Mounting Kit to our Service Depot. Recordex will pay for return shipment of repaired Mounting Kit or replacement Mounting Kit under warranty. Return shipment will be by ground service to the 48 contiguous US states. You are responsible for shipping to Alaska, Hawaii and any address outside of the United States. If the Mounting Kit is repaired out of warranty then you are responsible for shipping both ways.

**What must I do to obtain warranty service?** To obtain warranty service please contact Recordex's Customer Service Center at 1-478-237-5501 or contact your authorized Recordex Dealer for assistance in filing a warranty claim. You will receive instructions on how to properly return your product for authorized warranty repair. In order to receive warranty service you must be able to provide an original receipt for the purchase of your Ceiling Mount (or other proof that you are the original owner).

THE ABOVE STATED WARRANTY IS EXCLUSIVE AND REPLACES ALL OTHER WARRANTIES EXPRESSED OR IMPLIED INCLUDING THOSE OF MERCHANTABILITY AND FITNESS FOR A PARTICULAR PURPOSE. RECORDEX WILL NOT BE HELD LIABLE FOR ANY OTHER DAMAGES OR LOSS INCLUDING INCIDENTAL OR CONSEQUENTIAL DAMAGES AND LOSS OF PROFITS OR REVENUES FROM WHATEVER CAUSE, INCLUDING BREACH OF WARRANTY OR NEGLIGENCE.

## *Type Conventions, Terms, and Symbols*

The following type conventions, terms, symbols, and abbreviations are used to make it easier for you to navigate the information contained in this Users's Guide.

### **Symbols**

**CAUTION:** Indicates a caution warning regarding operation of the system that may lead to personal injury or damage to the autoprinter. Be sure to take careful note of any instruction flagged with a caution symbol.

# Introduction

## Customer Support

Your Infinix SCM Mounting Kit was subjected to rigorous quality control testing and inspection, however, if you encounter a problem during installation please contact our support department so we quickly resolve the issue. We strive to build the best product possible and we desire that every customer feel confident recommending Recordex products. If you are not fully satisfied please call our Customer Service Center today and we will do our best to make things right.

Customer Service Center  
Recordex USA, Inc.  
PO BOX 848  
105 North Anderson Drive  
Swainsboro, GA 30401  
P. 1-478-237-5501  
F. 1-478-237-5504

## Safety Precautions



Please read through these important safety precautions and recommendations before setting up your Infinix SCM.



This installation guide includes important information and a thorough understanding of the guide is necessary to ensure proper installation. Failure to read, fully understand, and follow the instructions found in this guide can result in serious personal injury, damage to the product and related equipment, and may render your product warranty void. The installer of this product is responsible for making sure that the Mounting Kit is properly assembled and installed.



This mount requires adequate structural support and the installer is responsible to make sure that the supporting structure can support up to 5 times the weight of all equipment attached to the Mounting Kit. Proper reinforcement of the structure may be required before installation. Inadequate structural support can result in serious personal injury, and damage to equipment.

This Mounting Kit is rated to support up to 50 pounds. Exceeding the weight capacity can result in serious personal injury or damage to equipment. The installer is responsible for making sure that the total combined weight of all product attached to this Mounting Kit does NOT exceed 50 pounds.

## Unpacking Your Infinix SCM™

Take a moment to make verify the contents:

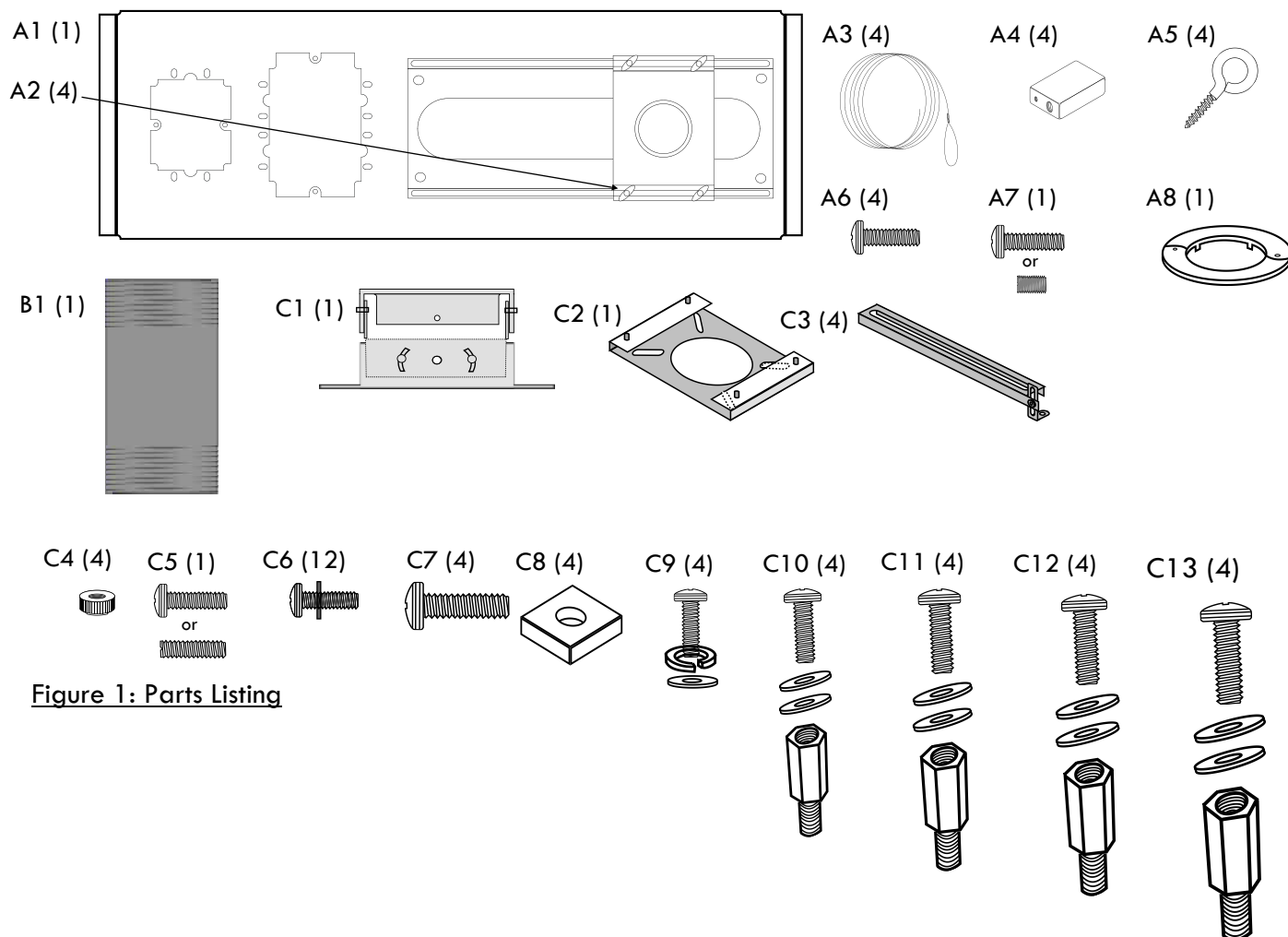
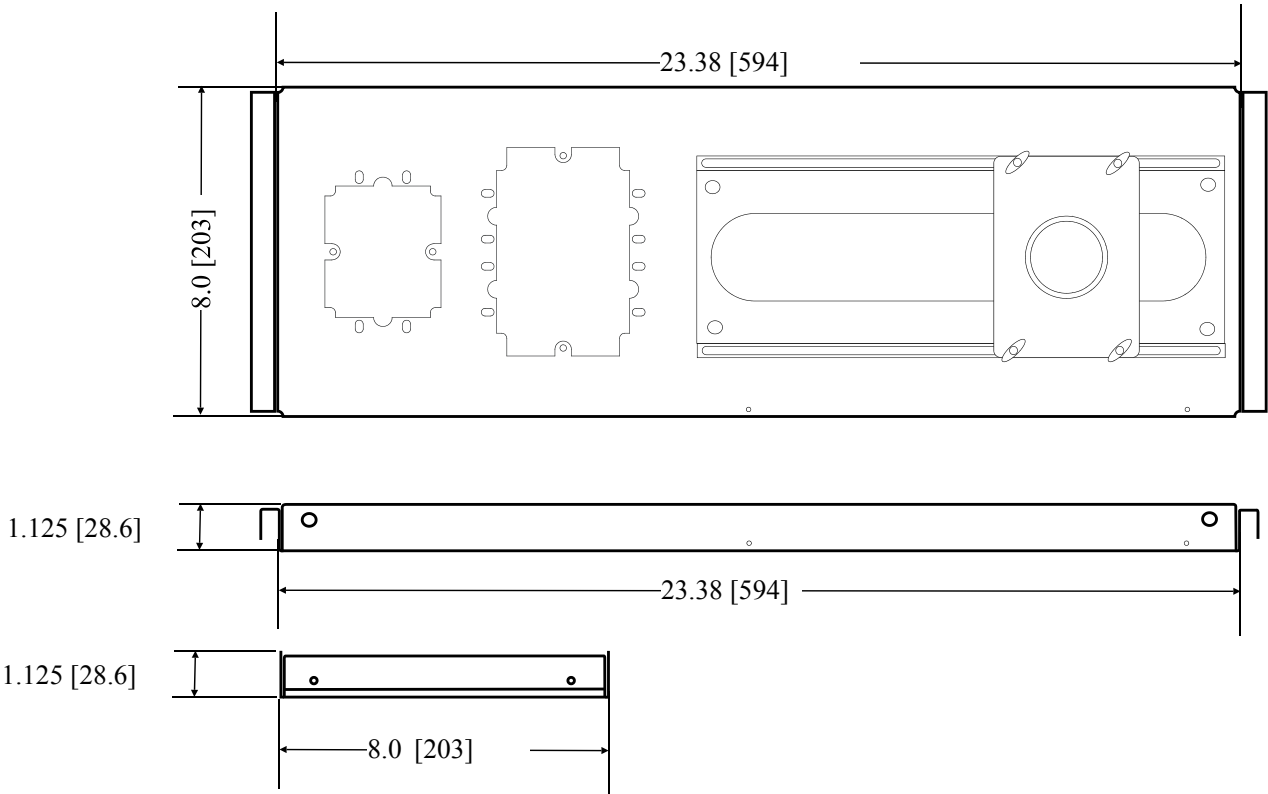

Figure 1: Parts Listing

#	QTY	DESCRIPTION	#	QTY	DESCRIPTION
A1	1	Ceiling Mounting Plate	C1	1	Adjustable Ceiling Mount
A2	4	5 mm Wing Nuts	C2	1	Universal Projector Sled
A3	4	1.6 mm x 7.6m (25 ft) Safety Wire	C3	4	Adjustable Spider Mounting Arms
A4	4	Fastlok Wire Locks	C4	4	Thumb Nuts
A5	4	Eye Lag Wood Screw (6.7 mm x 33 mm)	C5	1	1/2" Set Screw (philips pan head or hex)
A6	4	#10 x 5/8" Screw (4.8 mm x 16 mm)	C6	12	#10-24 x 1/2 Pan Head Screw w/Nylon washer
A7	1	1/4" Set Screw (philips pan head or hex)	C7	4	Pan Head Screw
A8	1	Finishing Ring	C8	4	Square Nut
			C9	4	Pan Screw w/Locking washer and flat washer
B1	1	3" or 6" Extension Pipe	C10	4	M3 Standoff with Screw & Washers
			C11	4	M4 Standoff with Screw & Washers
			C12	4	M5 Standoff with Screw & Washers
			C13	4	M6 Standoff with Screw & Washers

# Dimensional Drawings

## Ceiling Mounting Plate-A1 (SKU:500SCT)



## Extension Column – B1 (3” or 6”) (SKU:500006)

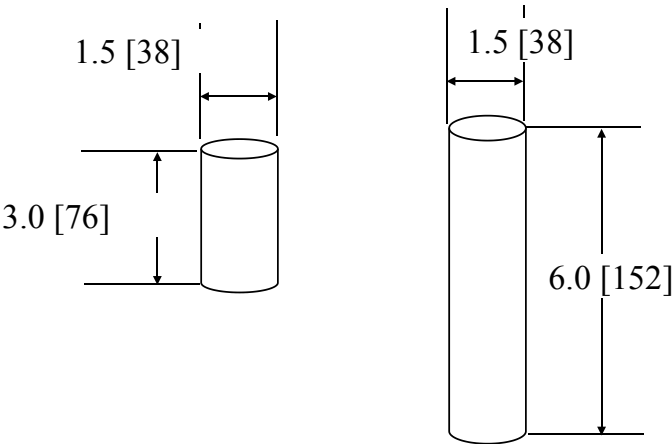

# Dimensional Drawings

## Adjustable Ceiling Mount–C1 (SKU:500UCM)

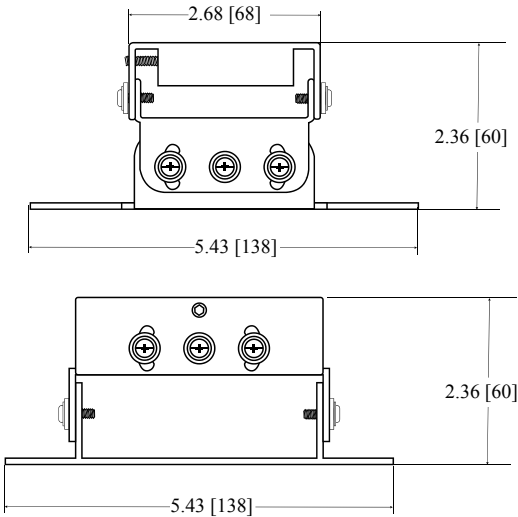
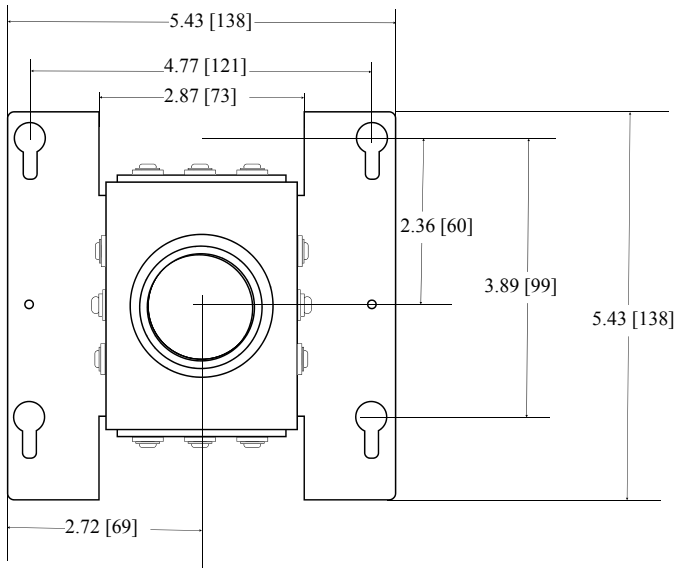
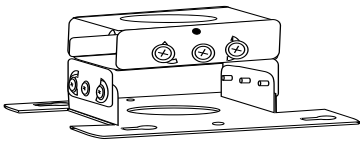

## Universal Projector Sled with Adjustable Spider Mounting Arms – C2 & C3 (SKU:500UCM)

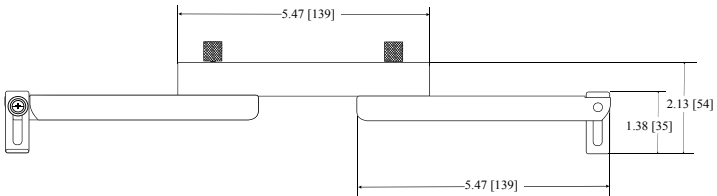
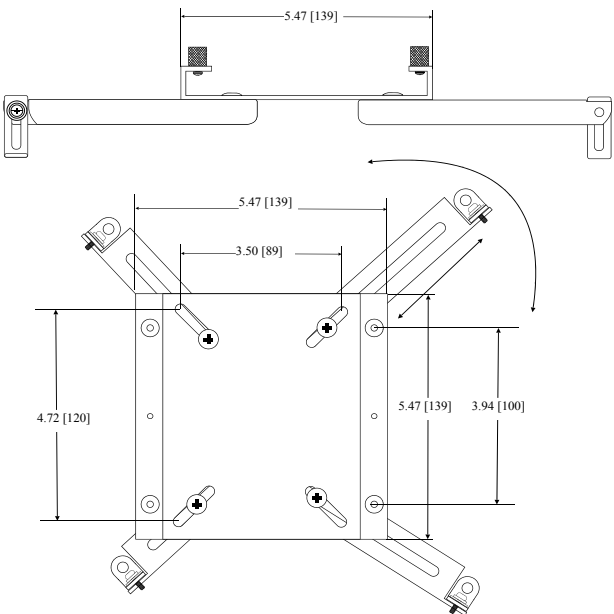

# Dimensional Drawings

## Optional Plenum Box (SKU:500PLB)

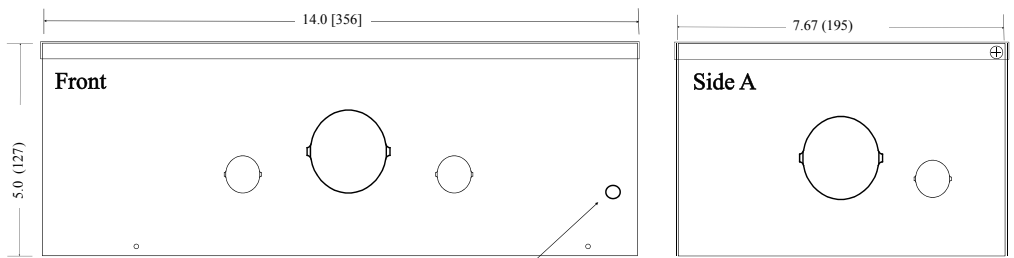

Holes to allow safety wire to pass through plenum.

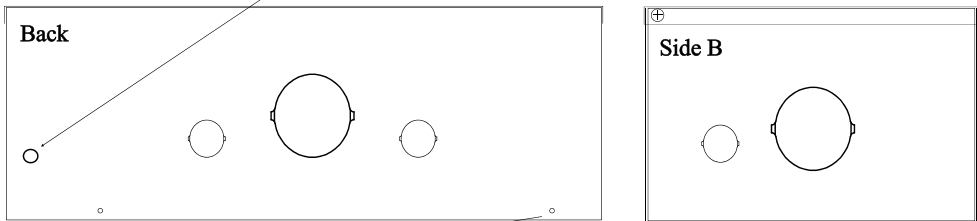

This is where the plenum box attaches to ceiling plate

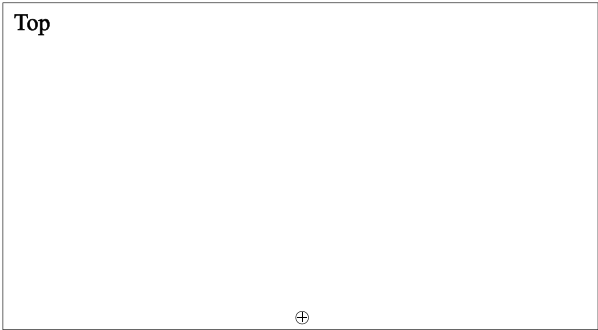

3D View from Top

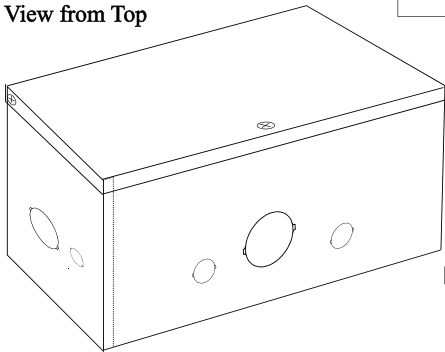

Installed on Ceiling Tray

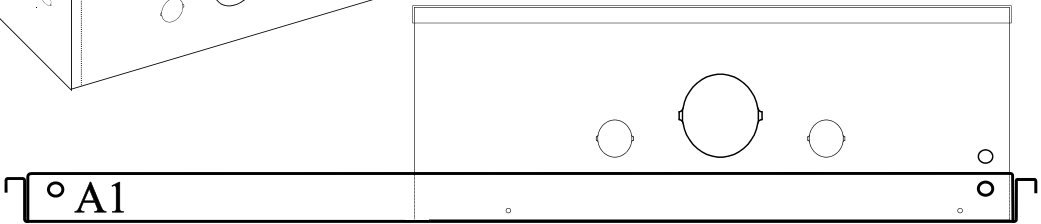



# Installation

## Tools Required For Installation

- Marking Pen or Pencil
- Hole Saw (2" diameter)
- Philips Head Screw Driver (#2)
- Ruler/Tape Measure
- Allen Wrench (included)

## Preparing Ceiling for Installation

Select the appropriate ceiling grid cell for installation of mount. This will be based on the recommended installation instructions for your projector. Refer to projector installation instructions to determine distance from projector to target surface. Identify the grid cell that meets your distance from target requirements then follow these steps:

1. Determine precise placement for the extension column and mark the center on the finished (down) side of the tile.  
TIP: Make sure that the Infinix SCM will fit in the desired location (consider orientation and placement of Infinix SCM).
2. Remove the tile from the grid.  
TIP: It may be helpful to remove adjacent tiles to improve access to the workspace above the ceiling.  
TIP: If you remove extra tiles place a mark the ceiling grid supports where the mount will be installed.
3. Use hole saw to cut 2" diameter hold in tile.
4. Replace tile into ceiling grid.  
TIP: Be sure to place the cut tile back into the proper ceiling grid cell.
5. Install the ceiling mounting plate (A1) on top of the ceiling tile you just replaced. Be sure that the short end (8") of the mounting plate (A1) straddles the taller 1½" primary ceiling grid rail to ensure adequate structural support (See Figure 2)
6. Loosen the four wing nuts (A2) and by moving the mounting plate along the ceiling rails and adjusting the position of the pipe coupling ensure that the pipe coupling for the extension column is positioned directly over the 2" hole cut from the tile.
7. Tighten the wing nuts.
8. OPTIONAL: The ceiling plate is designed to accept standard electrical gang boxes. If these are to be used then mark the position of the gang box knockouts.
9. Identify the optimal location to secure the four safety wires (A3) using these guidelines:
  - do not anchor wires directly above the support holes rather anchor wires approximately 10 to 15 degrees away from the support holes, but not more than 20 degrees (See Figure 3).
10. Mark where the safety wire anchors should be installed.
11. Remove the Ceiling Mounting Plate and the ceiling tile.
12. OPTIONAL: Cut out gang box opening where marked in step 8 above.

Figure 2

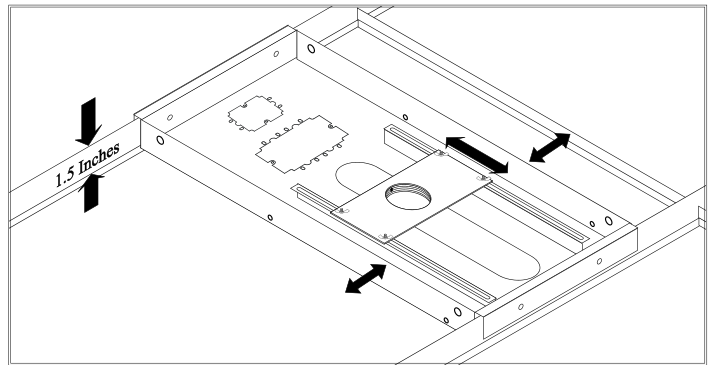
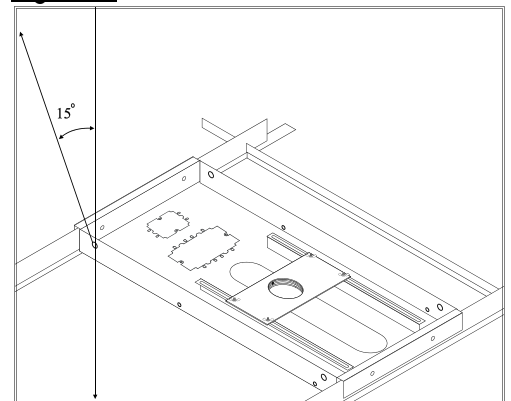

Figure 3



## Safety Wire Installation

- !** This mount requires adequate structural support and the installer is responsible to make sure that the supporting structure can support up to 5 times the weight of all equipment attached to the Mounting Kit. Proper reinforcement of the structure may be required before installation. Inadequate structural support can result in serious personal injury, and damage to equipment.
- !** This Mounting Kit is rated to support up to 50 pounds. Exceeding the weight capacity can result in serious personal injury or damage to equipment. The installer is responsible for making sure that the total combined weight of all product attached to this Mounting Kit does NOT exceed 50 pounds.
- !** Failure to properly install safety wires may result in serious personal injury and damage to equipment. Installer is responsible for inspecting the wood, concrete and steel structure to ensure that it is sound and capable of providing adequate structural support.
- !** Concrete anchors must be installed into solid concrete, hollow concrete block will not provide adequate structural support. Concrete anchors should not be installed within 2½" of concrete edge.

### Wood Structure

If installing into wood follow these directions:

1. Drill a 0.113" (#33 bit) pilot hole into the four locations where previously marked.
2. Twist the four wood eye lag screws (A5) into the pilot holes.
3. Use the loop end of the safety wire to easily secure the wire to the eye lag. (See Fig 4)
4. Do **not** secure wires to tray. Proceed to next page.

Figure 4. Wood Structure

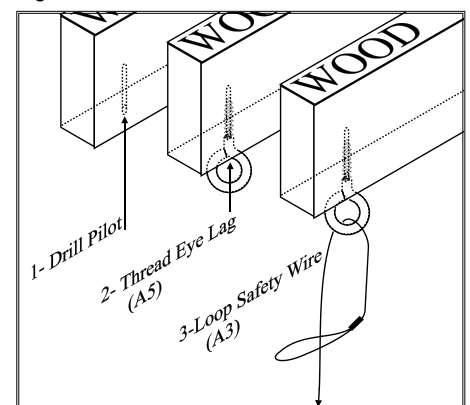

Figure 5. Steel Truss

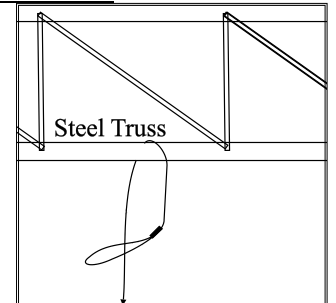
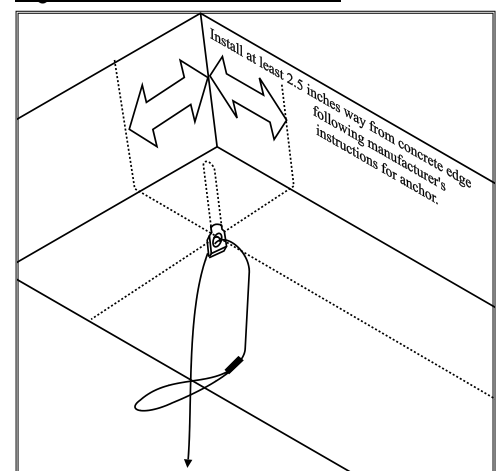

Figure 6. Concrete Structure



### Steel Truss Structure

If installing over steel trusses follow these directions:

5. Use the loop end of the safety wire to easily secure the wire to the truss (See Fig 5) where previously marked.
6. Secure all four safety wires.
7. Do **not** secure wires to tray. Proceed to next page.

### Concrete Structure

If installing into concrete follow these directions:

8. Select proper concrete anchors (capable of bearing a minimum load of 250 pounds of tension).
9. Install concrete anchors according to the manufacturers recommended installation method.
10. Install a concrete anchor at four locations where previously marked.
11. Use the loop end of the safety wire to easily secure the wire to the concrete anchor. (See Fig 6)
12. Do **not** secure wires to tray. Proceed to next page

## Ceiling Mounting Plate Installation

1. Replace the ceiling tile, with the hole cut for the extension column into in the ceiling grid. Make sure you have the tile oriented correctly.
2. Install ceiling mounting plate (A1) on ceiling grid above the tile.
3. Position the plate (A1) on the grid, and position the pipe coupling to make sure that it lines up with the hole cut from the tile.
4. Secure plate to ceiling grid using the #10 x 5/8" screws (A6).
5. Thread the safety wires (that should be hanging from the anchors that were installed in the last section) through the fastlok wire locks, through holes in the end of the ceiling mounting plate, and then back through the fastlok wirelock (See Figure 7).
6. Tighten the wires so that the full weight of the ceiling mounting plate is supported by the safety wires. The ceiling grid should not be supporting the weight of the mounting plate. **DO NOT OVER TIGHTEN** the safety wires, doing so could cause damage to the ceiling grid.

Figure 7. Install Plate & Tighten Safety Wires

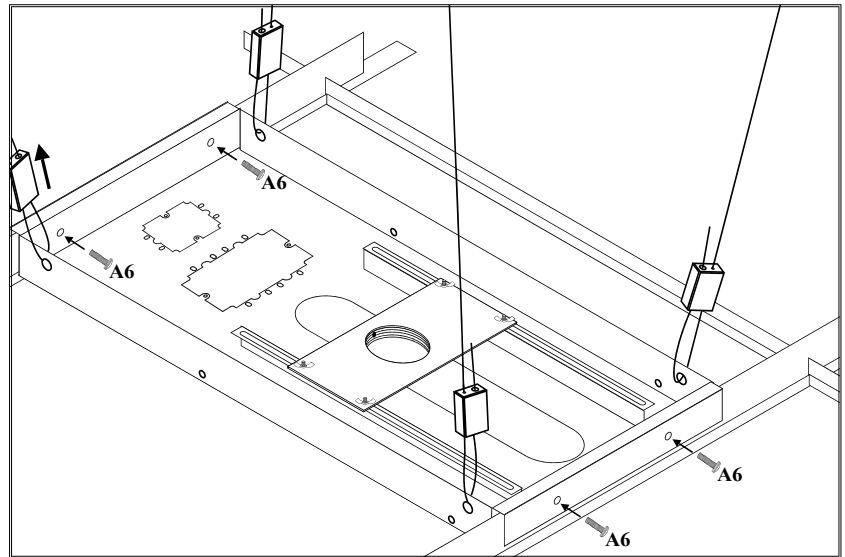

## Extension Column Installation

1. Thread the extension column through the hole in the ceiling tile and into the pipe coupling of the ceiling mount plate.
2. Thread the pipe as far as desired and then secure the pipe with the pan head screw\* (A7).  
NOTE: You will need to loosen the set screw to adjust column height if adjustment is necessary.
3. Install the finishing ring around the extension column to cover the edges of tile where the hole was cut.

\*some kits may ship with 1/4" hex head set screw

Figure 8. Extension Column

A7 Set Screw



## OPTIONAL: Plenum Box Installation

The plenum box is designed to help reduce fire hazard by containing heat and flame to the plenum box if an electrical fire were to begin inside the plenum box. The plenum box (ITEM: 500PLB) is available from any Authorized Recordex Reseller.

1. Place plenum box on over the area of the ceiling mount plate where the extension column attaches.
2. Line the plenum box up with the mounting holes on the side of the ceiling mounting plate.
3. Securely attach the plenum box using the included hardware (4 self-tapping pan head screws)
4. Remove knock-outs as needed to facilitate cabling and wiring to the plenum box.

Figure 9. Optional Plenum Box

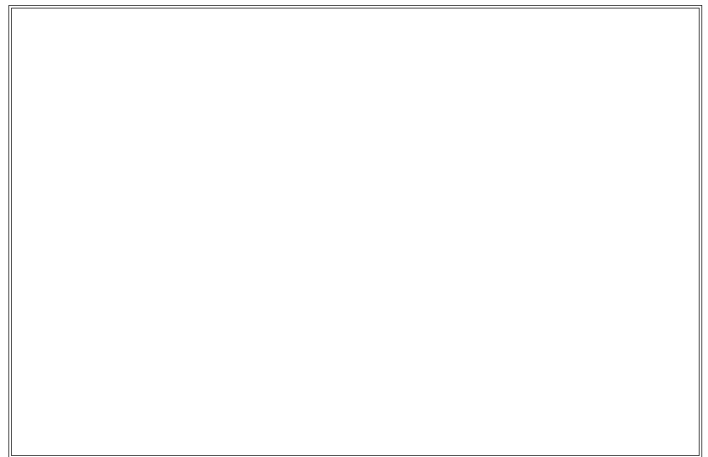

## Projector Mount Installation

The projector mount will attach to the Ceiling Kit using the extension column.

### ***Installing the Adjustable Projector Mount to the Extension Column***

1. Separate the top portion of the projector mount (C1) from the bottom portion (C2, universal projector sled) by loosening the thumb nuts and removing the sled.
2. Thread the Adjustable Ceiling Mount (C1) onto the extension column (B1) at least ½ inch (see Figure 10).
3. Tighten the set screw (C5) to temporarily set the mount position. To make a final yaw adjustment you will need to loosen the set screw, adjust the mount, and then re-tighten the set screw.

### ***Attaching a Projector to the Universal Projector Sled***

4. Determine the proper standoffs to use with your projector. M3, M4, M5 and M6 standoffs are provided with the mount and one of these sizes should fit any standard projector.
5. Thread the appropriate standoff into the mounting holes on the bottom of the projector.
6. Align the universal mounting arms (spider arms) so that they line up with the projector's mounting holes.  
NOTE: If the projector only has three mounting holes then you can remove one of the spider arms or you can leave it attached to the mount for possible future use. Position the unused arm out of the way and tighten the thumb screw.
7. When the universal mounting arms (C3) are lined up with the standoffs then use the screw and washer provided with the standoff to attach the mounting arm's adjustable mounting foot with to the standoff (see Figure 11). Repeat for all three or four mounting points.
8. After the project is secured to the mounting arms securely tighten the screws (C7) to ensure that the mounting arms will not move out of their current position (Figure 12)

Figure 10. Thread Mount

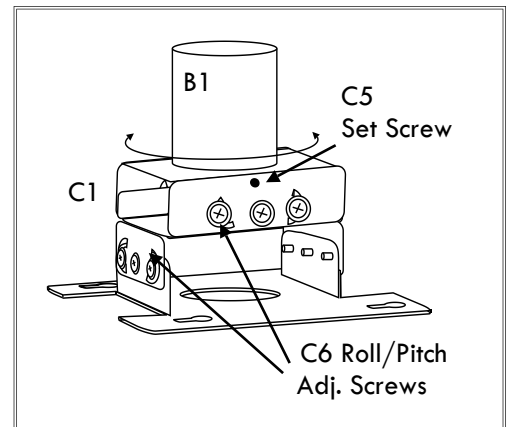

Figure 11. Attach Sled to Projector

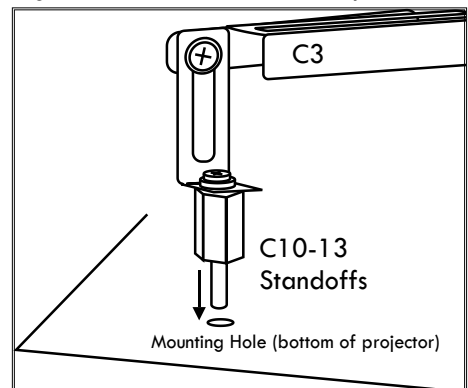
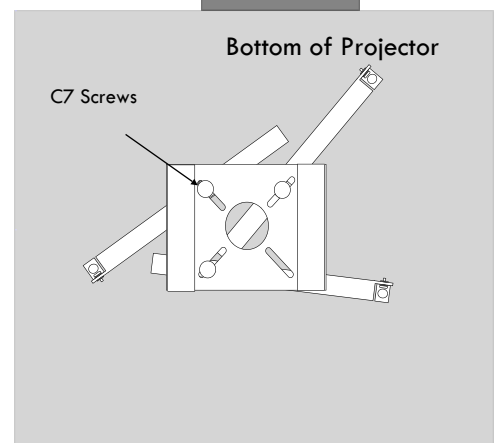

Figure 12. Secure Mounting Arms



## ***Attaching the Universal Projector Sled & Projector to the Ceiling Mount***

1. Attach the universal projector sled (C2) to the Adjustable Ceiling Mount (C1) and secure in place by tightening the four thumb nuts (C4) (See Figure 13).

### ***Making Final Adjustments***

2. The Adjustable Ceiling Mount (C1) can be adjusted for roll, pitch and yaw.
3. The yaw adjustment is made by loosening the set screw and threading the mount (C1) clockwise or counter clockwise on the extension column. Be sure to re-tighten the set screw after making the final yaw adjustment.
4. The pitch adjustment is made by loosening the four adjustment screws (C6), two on the front and two on the back, making the pitch adjustment, and then tightening all four screws to set the position.
5. The roll adjustment is made by loosening the four adjustment screws (C6), two on either side, making the roll adjustment, and then tightening all four screws to set the position.

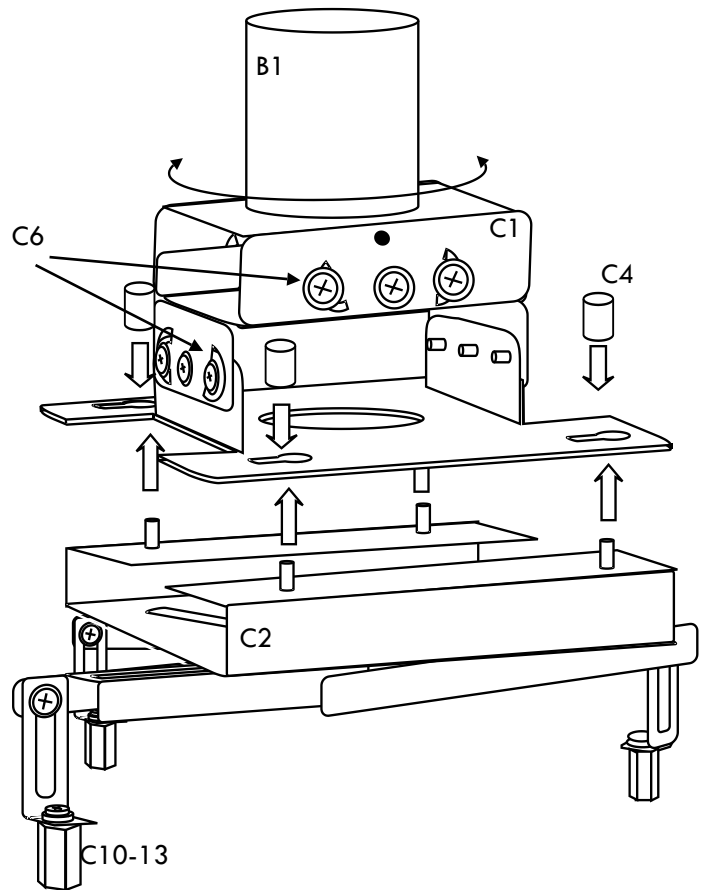

Figure 13. Attach Projector & Sled to Ceiling Mount

## ***Appendix A: Technical Support***

Every Infinix SCM™ is rigorously tested before it is shipped to ensure trouble free operation. However, if you find you need assistance or need to report a problem with your mount don't hesitate to give us a call.

### **Contact Technical Support**

#### ***Mailing Address***

Recordex Technical Support  
PO BOX 848  
Swainsboro, GA 30401

#### ***General Phone***

1-478-237-5501

#### ***Fax Number***

1-478-237-5504

#### ***Email***

service@recordexusa.com

### **CHECKLIST**

1. Make sure you've read this manual thoroughly before calling.
2. Write down the model number & serial number of your duplicator.

Model#: \_\_\_\_\_

Date of Purchase: \_\_\_\_\_

Place of Purchase: \_\_\_\_\_

4. Call 478-237-5501 ask for technical support.